

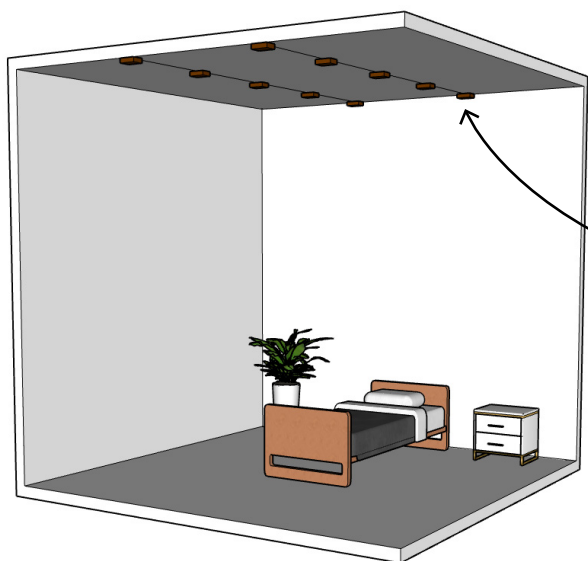

Faux Wood Beam General Installation:

1. Acclimate beams in the room they are being installed in for a minimum of 48 hours prior to install, laying flat and away from moisture, sunlight, or other heat sources. Mark lines on ceiling with a chalk line, laser, or painters tape where beams will be installed. Determine the number of wood blocks needed (blocks should be installed at ends of beams and every 2-3 feet apart). Cut blocks $\frac{1}{8}$ " narrower than the inside width of the beam, apply PL Premium adhesive to the blocks, and fasten blocks to ceiling (figure 1). If a ceiling joist is present, use screws to fasten blocks into joists. If a ceiling joist is not present, use heavy duty toggle bolts.
2. Trim beams to the required length with woodworking tools. Hand saw is recommended, as some beams may include hidden fasteners. NOTE: Cut $\frac{1}{8}$ " longer than opening to 'spring' the beam into place. Do not cut beams short.
3. Apply a generous and continuous bead of PL Premium polyurethane construction adhesive at the beam's top ends on both sides, and ends and sides of blocks. Push beam up to ceiling and over blocking, applying pressure. Use four trim screws per block (two per side) and slightly countersunk to fasten beam into blocking (figure 3).
4. Fill gaps and holes with colored caulking.

FIGURE 1



Fasten blocking with adhesive and screws (or heavy duty toggle bolts) at ends and approximately 2-3 feet apart.

FIGURE 2

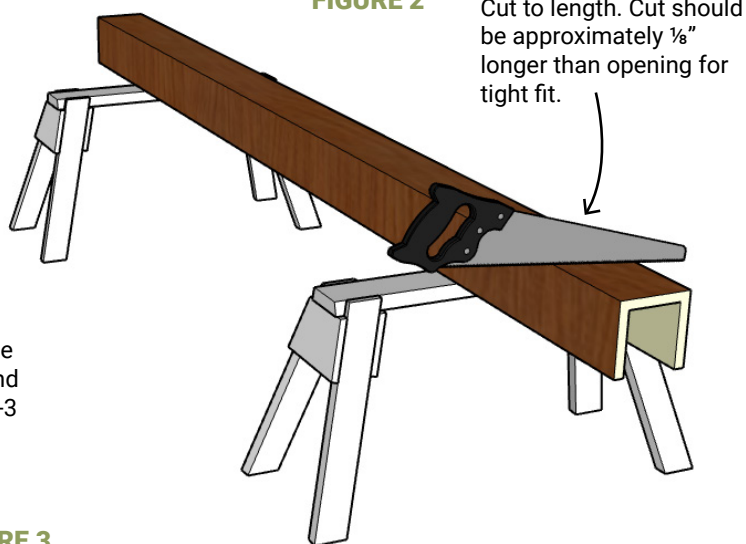

FIGURE 3

Adhesive (apply to end blocks)

Adhesive (apply to all blocks sides and top)

Adhesive (apply continuous bead to both sides)

Slide beam over wood blocking, then fasten beam to blocking with trim screws on both sides.

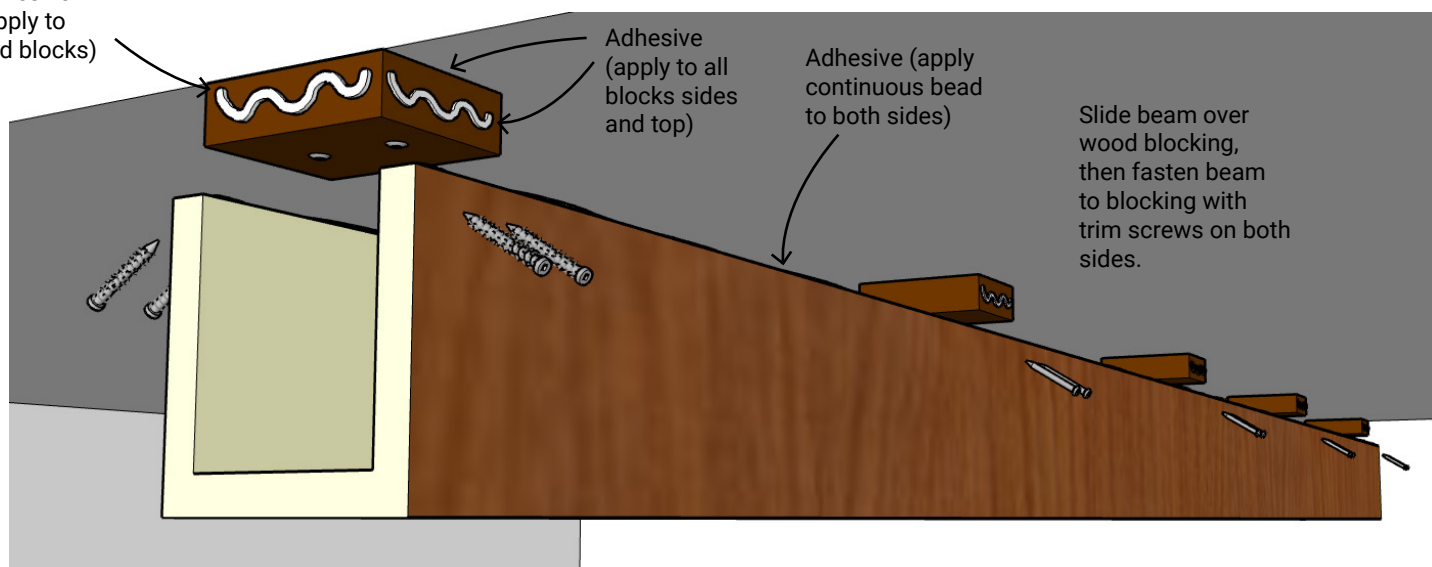

Splicing Faux Wood Beams

DISCLAIMER: If joining two beams on the ends to make a longer continuous beam, beam straps are strongly recommended to conceal the joint. If not using beam straps, beam splices are performed at the customer/installer's sole discretion. Additional steps must be taken to minimize expansion and contraction at the seam.

1. If splicing beams together to make a longer continuous beam without beam straps, fasten blocking to ceiling as outlined in general installation guide. Blocking where the two beams connect must be installed, and should be long enough to fasten screws through both beams into the blocking. Blocking should have PL Premium adhesive applied to the sides to adhere beam's interior walls to blocking. Fasten additional blocking into lower part of the beam with a minimum of two trim screws and fasten the blocking through the beam (figure 1).
2. With the beam cut $\frac{1}{8}$ " longer than the opening, spring the beam into place between the wall and the already-installed beam.
3. Fasten beam into the upper and lower blocking with minimum of two screws per side and two screws on the bottom (figure 3).
4. If desired, conceal the seam by using wood putty filler to blend the texture of the two beams (for unfinished beams only), then paint/stain. Apply colored caulking and touch up screw holes (figure 4).

FIGURE 1

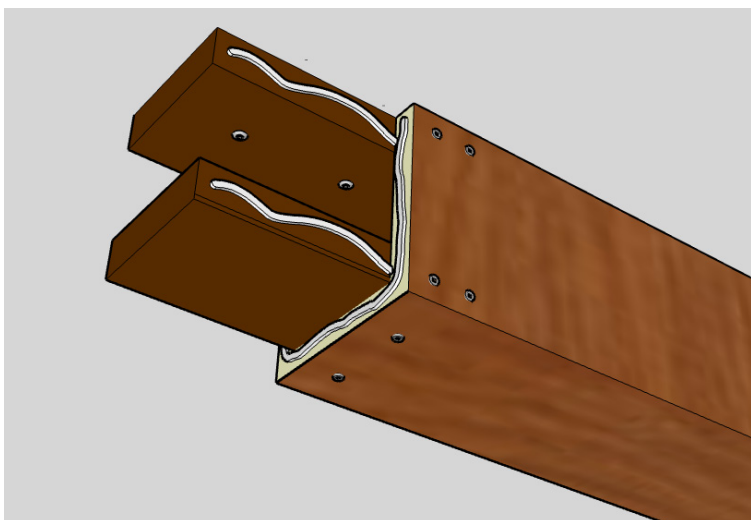

FIGURE 3

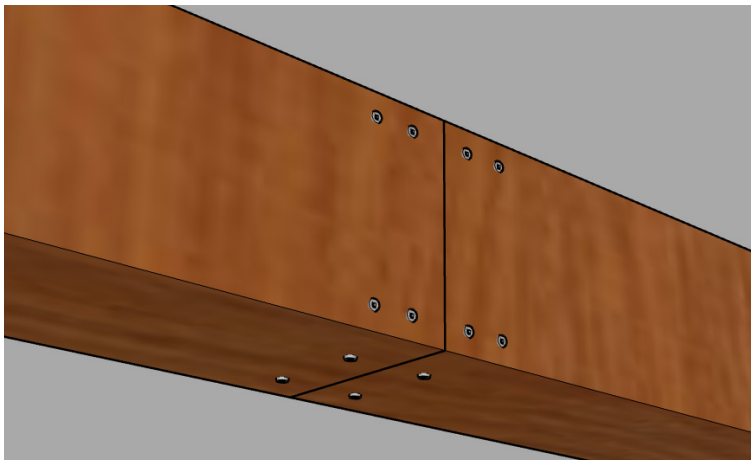

FIGURE 2

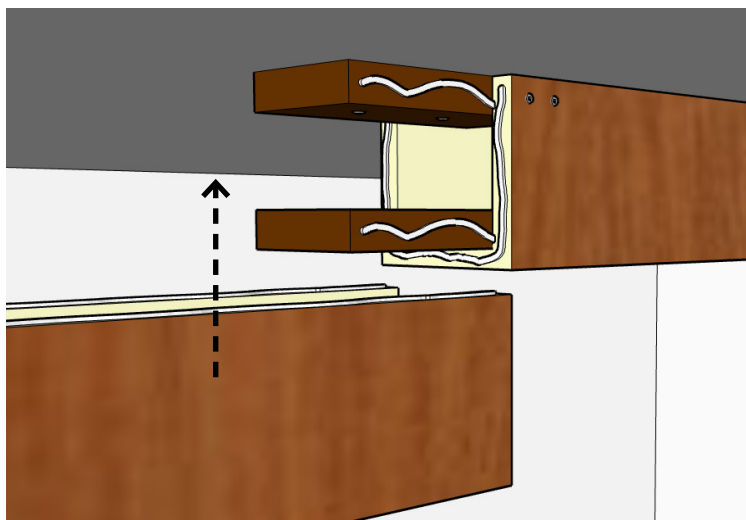

FIGURE 4





IMPORTANT INSTALLATION AND PRODUCT NOTES:

- Always take appropriate safety precautions including use of protective eyewear, footwear, gloves, etc.
- Beams may expand and contract. Following this installation guide will help to minimize the affects of expansion and contraction, but may not eliminate them entirely.
- Beams are non-structural and should be used purely for decorative purposes. Beams should not be used for any supportive purposes.
- Beams must be acclimated in the room they will be installed in for a minimum of 48 hours prior to installation.
- Factory stained beams are finished by experienced stain artists. Results can vary batch to batch due to the nature of the hand-finishing process. For most consistent results, purchase all beams at the same time.
- Actual color may vary from website and catalog images due to monitors, lighting, and other factors.
- Timberthane and Heritage faux beams are manufactured from high density polyurethane and may be cut, trimmed, drilled, and fastened with woodworking tools.
- GENERAL DISCLAIMER: Consistent with decorative building product/industry norms, faux beams may require alterations to product and/or methods depending on site and other conditions. Installation instructions are intended to be general in nature. Installers should always use good discretion for the given site conditions and application.

Typical Beam Installation Detail

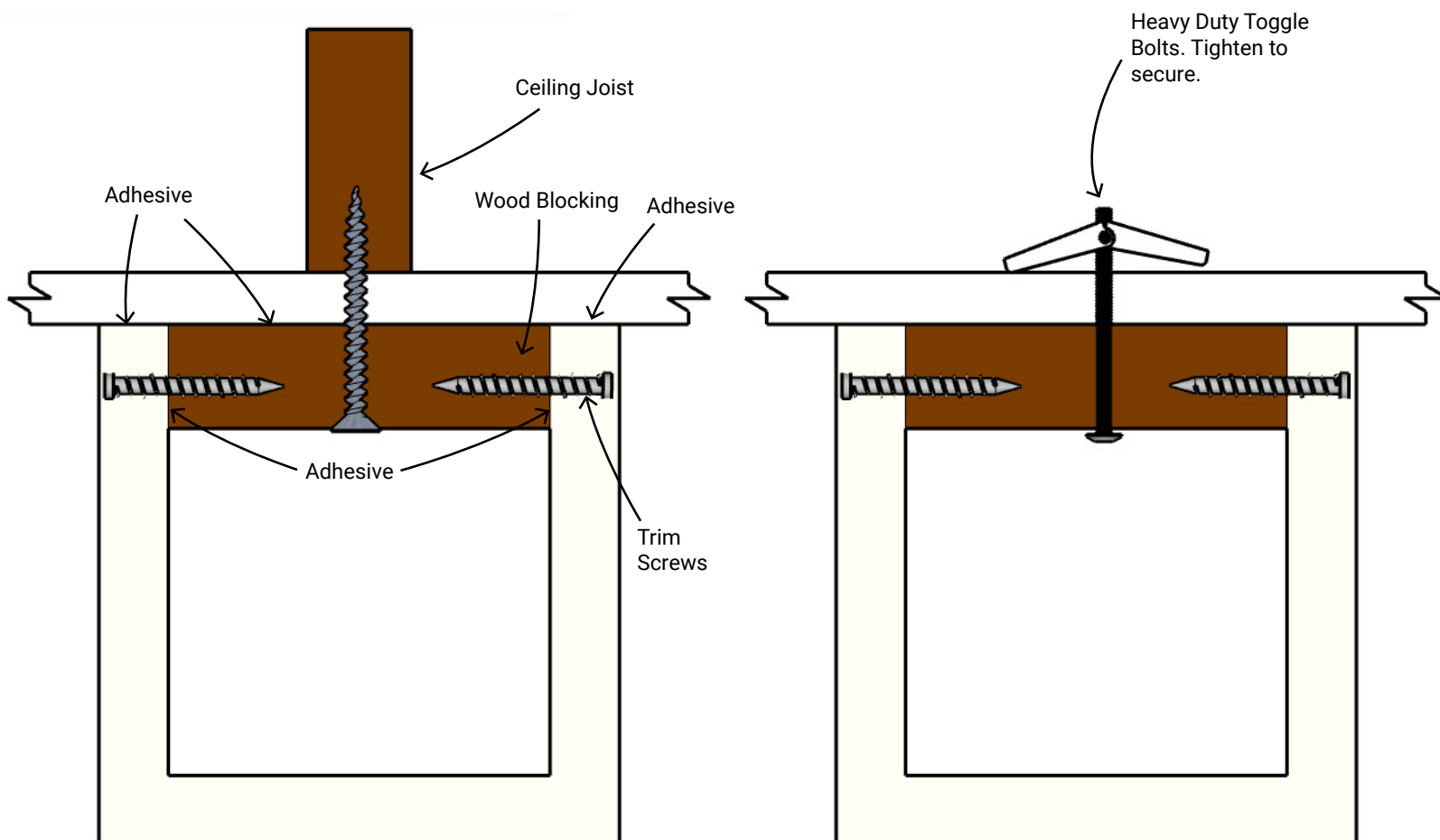



Attaching a Fan or Chandelier

DISCLAIMER: Follow all building codes and consult with a licensed electrician when necessary. Faux beams are suitable for decorative use only and are not recommended for support purposes.

1. Secure wood blocking to a ceiling joist (or use toggle bolts if necessary). Wood blocking should fill the space between the electrical box and the outside of the beam.
2. Trace a template of the electrical box onto the beam where chandelier or fan will be mounted, then cut hole using a jig saw.
3. Install the beam following installation guide.
4. Connect the chandelier or ceiling fan fixture.

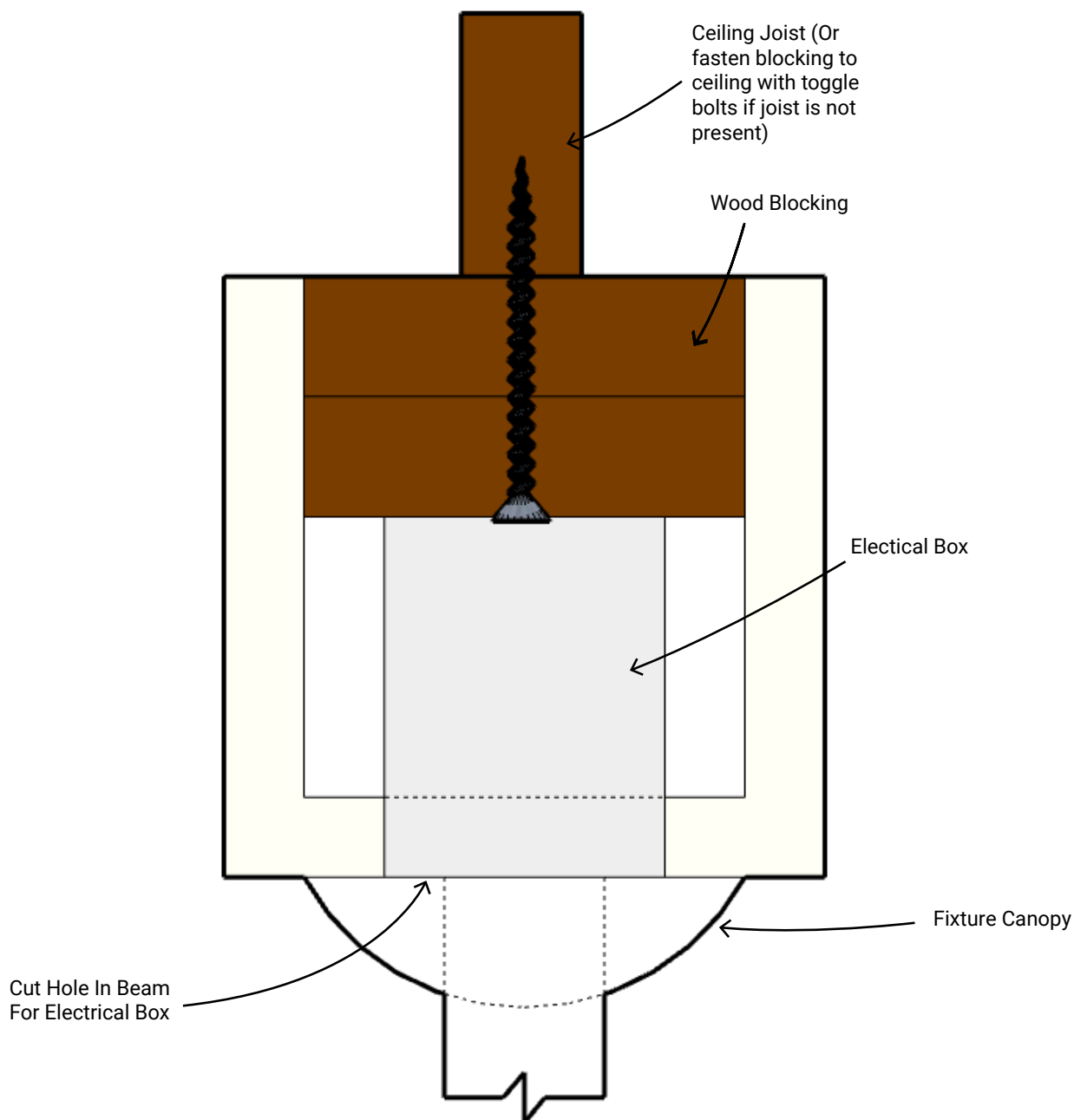



Faux Wood Beam Staining Instructions

1. Thoroughly wipe down the beam with a damp cloth, removing any dust or debris. Compressed air can be used to blow off any dust trapped in wood-grain.
2. Paint beam with base coat color of choice with high quality acrylic latex paint. Allow paint to fully dry, following paint manufacturer's recommendations. NOTE: If using Heritage brand beams, base coat paint step may be bypassed if desired, as the Heritage brand beam's tan color base-coat is considered stain-ready. Or, paint if a different base coat color if desired.
3. Apply a non-penetrating stain such as gel stain in color of choice. Be sure stain is well-mixed before applying, as improperly mixed stain will not dry properly. Apply the stain with a brush directly onto the beam's surface, working stain into the wood-grain texture. If beams are longer than 10', apply stain in sections.
4. Wipe off non-penetrating stain with a rag until desired tint is achieved. As more stain is wiped off, the color appears lighter. For darker tints, wipe off less stain. Allow proper dry time following stain manufacturer's recommendations.

Factory Stained Beams - Finish Variation Notice

Beams are hand-finished to replicate the natural character of real wood by professional stain artists. Slight variations in color and tone may occur between production batches due to the nature of the hand finishing process. Orders placed at different times may result in slight color variations. For the best color consistency, order all beams necessary for the project at the same time. Actual color may vary from website and catalog due to monitors, lighting, and other factors.

